



# User manual



# Starter Set Plaster

# **Instructions for use**

The **starter set plaster**, with prefabricated tunnels and chambers, is suitable for various ant species. Especially for species that build their nests in very stony and sandy soils.

**Note:** The nest is to be used in a dry and slightly moist formicarium. If the nest is kept permanently moist, the material may mould.

## **Step 1**

### **Search for a suitable location**

In order not to expose the ants to unnecessary vibrations and temperature fluctuations, a suitable and stable site should be selected.

Attention:

- do not place near windows (sunlight)
- not place near radiators
- do not place on vibrating surfaces
- Do not place near music equipment
- Do not place near noisy machines
- do not place over electrical appliances
- not place in a room with strong odours (e.g. kitchen)
- do not place in a smoking room

## Step 2

### **Control**

Check the complete contents of the kit to make sure everything is in stock.

### **Content:**

- 1x ANTCUBE - Arena 20x20x10 - flat
- 1x Ant Arena Frame 20x20
- 1x Ant Arena Cover 20x20
- 1x ANTCUBE - ant farm - L - 20x20 - standing
- 1x ANTCUBE - plaster nest 20x20 - standing
- 1x 0.5m hose transparent 14/10 mm
- 1x ANTCUBE - Red foil 20x20 - self-adhesive
- 1x Substrate - Sand-Loam white - 1000g
- 1x Grille insert - 50mm - stainless steel
- 1x Formicarium plug for 50mm hole
- 1x Formicarium plug for 27mm hole
- 1x grid cap - 16mm - stainless steel
- 1x basin connector for bore 27 and hose 10-16 mm - M25
- 1x Formicarium nut M25 - grey
- 1x Drinking trough 2ml - 360 degrees
- 1x food dispenser 2ml - dosable
- 1x Mini Thermo- Hygrometer analogue - Display - hanging
- 1x Ant Ant Outbreak Protection Oil 10ml
- 1x tweezers spring steel - wide - soft
- 1x tweezers plastic transparent
- 1x plastic pipette 3ml
- 1x Hand magnifier - 2x - 30mm
- 1x Food Mix Set - Standard + Sponge
- 1x foam wiper 150x18x2,5mm

### Step 3

#### **Assembly**

- First, fill the **ANTCUBE - Arena 20x20x10 - flat** with the **substrate - sand-loam white - 1000g** mixture. The layer should **not be higher** than 1-2mm, otherwise there is a risk that the ants will dig themselves in and not use the farm or nest area intended for them.



- The **ANTCUBE - plaster nest 20x20 - standing** is inserted into the **ANTCUBE - ant farm - L - 20x20 - standing**. To do this, the farm should be held at a slight angle when inserting the nest. The lid is then placed on the farm.



- The **basin connector for hole 27 and hose 10-16 mm - M25** is now screwed to the arena. To do this, the **0.5m transparent 14/10 mm hose** is inserted into the connector and screwed tightly with the **formicarium nut M25 - grey**. The end of the hose is now pushed onto the socket of the farm and connected together.

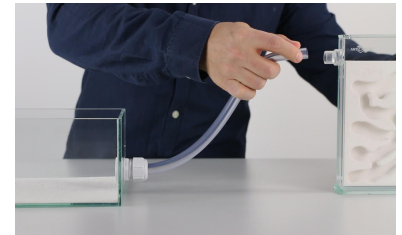

- With the existing **grid cap - 16mm - stainless steel** and the **formicarium plug for a 27mm hole**, the still open sockets of the farm and the arena are closed.

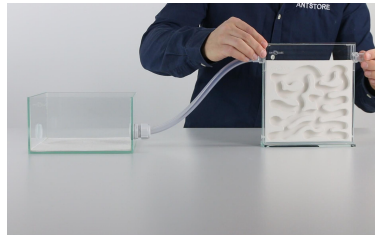
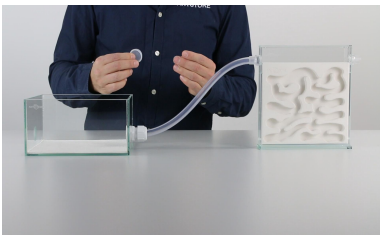

- With the help of the **plastic pipette 3ml**, the **drinker 2ml - 360 degrees** is now filled and food is added to the food **dispenser 2ml - dosable**. These are then placed in the front area of the arena. This facilitates food control and makes it easier to see if the containers need to be cleaned.



- When everything has been placed correctly, the **mini thermo-hygrometer analogue - display** - is attached to the underside of the frame (**Ameisenarena frame 20x20**) in a **hanging position**. For this purpose, the protective film of the adhesive surface must be removed.

**IMPORTANT:** The thermo - hygrometer must be attached to the inside of the frame and **not to the outside of the frame**, otherwise the frame will not fit on the arena. There is only one attempt at fixing, as the glue holds very well and it is difficult to remove it later.



- The **ant escape protection oil 10ml** is now applied to the inner frame. For this we use the **foam wiper 150x18x2.5mm**. Alternatively, a household cloth or your own finger can be used. The layer should only be applied very thinly!



- The frame is placed on the rubberised rim of the arena. Please make sure that the frame is securely closed to the arena.



**The arena is now safe and the animals can no longer escape through the oil!**

If required, the supplied **ant arena cover 20x20**, with the two interchangeable inserts **grid insert - 50mm - stainless steel** and **formicarium plug for 50mm hole**, can of course also be placed on the arena frame. The grid insert ensures a good air exchange.

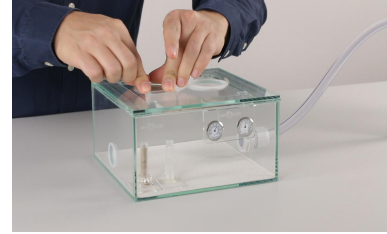
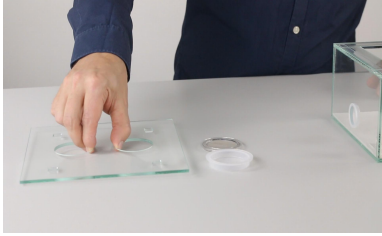

Depending on the ant species, the plaster nest is filled with water using the pipette. It is important to note that only the upper chambers are moistened very slightly by only adding the water drop by drop, for example through the side sockets of the farm. The discolouration from light to dark is very easy to see. Water dissolves the plaster after some time, so please use only soft water (rainwater, osmosis water, non-salty mineral/ or still water).

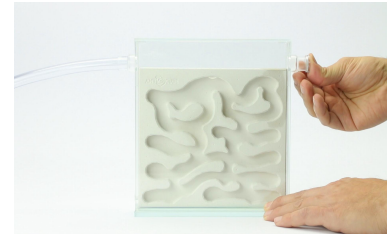

If necessary, the **ANTCUBE - Red Film 20x20 - self-adhesive** can be placed on the front area of the farm to give the ants an underground feel and the chance to build closer to the glass.

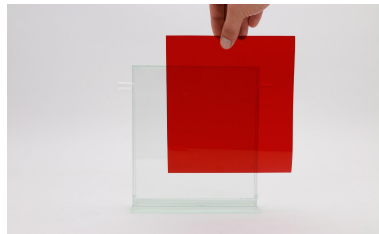

## Step 4

### **Settling the colony**

Before we insert the nest tube with the ants, we moisten the arena slightly with water. For this we use a spray bottle or the pipette provided. The sand must not be dusty, as this is not so healthy for the animals.

Now remove the plug from the nest tube and place it in the arena so that the ants can get used to their new environment and move in. When all the ants have moved in, the empty tube can be removed again.

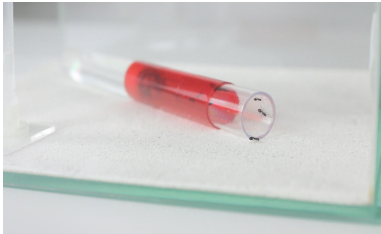

Ants are very clean animals that carry their waste out of the nest. Nevertheless, it can happen that the animals place their waste in the nest. This can happen especially with small colonies living in a nest that is too large. In order to minimise the formation of waste, only a small area should initially be offered to the animals in finished nest systems. Access to other chambers can be blocked with suitable soil substrate, so that the animals can only open the other passages and chambers as the colony grows and then use them for themselves. For this purpose, you can use the supplied sand-loam substrate, which must be slightly moistened before introduction.

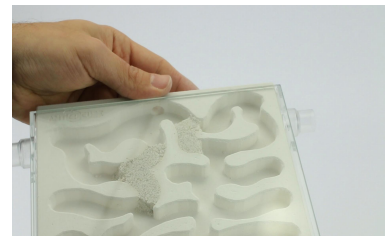
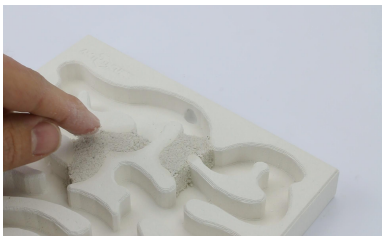

### Explanation of individual components:

The **arena** serves as an exercise area. The animals can transport their waste there and bring their food and water from the arena to the nest.

The **frame** is placed on the arena as a break-out protection.

- The **cover** is an additional break-out protection. The holes can be closed with **plugs or grid inserts** for ventilation.

The **farm** serves as a nesting area for the animals, where the queen and about 90% of the workers stay with the brood.

- The **hose connector** is suitable for the transition from the arena to the farm and is important for the transport of food and waste.

- The **substrate** is used to create a natural substrate for the animals in the arena and can also be used to close off part of the chambers in the plaster nest.

The **thermo-hygrometer** is used to monitor the temperature and humidity in the arena.

- The **break-out protection oil** additionally serves as protection on the frame. The animals find no adhesion through the oil film and cannot run over the protection.

The tweezers **plastic transparent** are used for gripping solid objects and the **tweezers spring steel - wide - soft** are used for gripping ants so as not to injure them.



- With the **hand magnifier - 2x - 30mm**, small objects can be observed well.



On our website you will find a helpful video especially for the Starter Set Plaster:



<https://www.antstore.net/shop/de/Ameisen-Starter-Sets-Ameisenfarmen-Antifonar/Starter-Sets---Gips-256/ANTCUBE-Starter-Set---Gips-5509.html>

Manufacturer:

ANTSTORE  
Selerweg 41  
D-12169 Berlin

Tel.	+49 30 766 870 51
Fax	+49 30 766 870 54

Email	<a href="mailto:verkauf@antstore.de">verkauf@antstore.de</a>
URL	<a href="http://www.antstore.de">www.antstore.de</a>